

Apartment Theo

Region: 3 Valleys Sleeps: 4

Overview

Apartment Theo offers a warm and contemporary base in the heart of Courchevel Village, placing guests within easy reach of the pistes and lifts of the world-class Three Valleys. Set on the third floor of a modern residence, the apartment blends light oak finishes with elegant alpine touches, creating a relaxed atmosphere that feels instantly welcoming after a day on the mountain. Large openings allow natural light to pour into the living space, while doors lead to a private balcony where you can enjoy crisp mountain air and quiet views across the village.

The open-plan layout has been thoughtfully designed for effortless alpine living. A comfortable lounge area invites you to unwind in front of the TV, while the dining space is ideal for sharing simple suppers or hearty ski-day breakfasts. The fully equipped kitchen provides everything you need for relaxed evenings at home, including fondue and raclette appliances for traditional mountain favourites.

Two well appointed bedrooms offer flexible sleeping arrangements, with the master featuring a double bed and its own ensuite bathroom complete with bathtub. The second bedroom includes twin beds and has access to an independent shower room, making the property ideal for a small family or two friends travelling together.

Guests benefit from the privacy of their own apartment while also enjoying access to residence facilities. A fitness room is available for those who like to keep active, and the wellness area provides a calm space to unwind. A ski locker, underground parking and elevator access add to the convenience, while the Grangettes lift and Tovets piste are only a short walk away, ensuring you can be on the slopes with ease each morning.

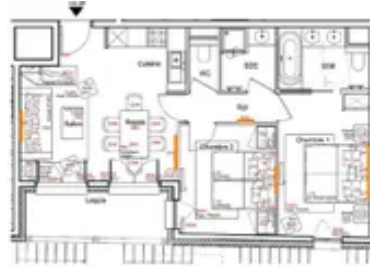

Facilities

Skiing • Ski Lift Nearby • Ski School Nearby • Walk To Slopes • Lakes and Mountains • Washing Machine • Coffee Machine • Hairdryer • Self-Catered • Ski-In/Ski-Out • Walking/Hiking Paths • Wi-Fi/Internet • TV • Garage • Gym/Fitness Room • Cots (Cribs) • Lift • Walk to Village • Modern • Chalet Apartment • Ski Locker • Bathroom Toiletries • Ideal for Kids • Ideal for Teens • Walk to Restaurant • Tumble Dryer • Dishwasher • Microwave • Safety Deposit Box • Sauna/Steam • Heating • High Chair(s) • Parking Space • Outstanding Landscapes • Outdoor Pursuit & Activities • Tourist Towns & Villages

Interior & Grounds

The Apartment (56 sqm)

Apartment Interior

- Living room
- Dining room
- Open and fully fitted kitchen
- Loggia
- Master bedroom: double bed (180 x 200), wardrobe, TV, ensuite bathroom, toilet with bathtub, double hand basin, towel dryer, hairdryer
- Twin bedroom with Two single beds (180 x 200), wardrobe and TV
- Seperate WC
- Independent bathroom with shower, towel dryer and single hand basin

Outside Grounds

- Garage
- Balcony
- Ski locker

Additional Facilities

- Lift
- TV
- Wi-Fi
- Baby cot and high chair (on request and subject to extra charge)
- Dishwasher
- Fondue appliance
- Kettle
- Microwave
- Nespresso coffee machine
- Raclette machine
- Washing-drying machine
- Wellness area with sauna, hammam, and gym



Location & Local Information

Apartment Theo enjoys a prime position in Courchevel Village, an inviting district known for its traditional charm and easy access to the vast Three Valleys ski area. The apartment sits just a short walk from the Grangettes lift, which carries skiers directly to Courchevel's main hub, while the Tovets piste offers a convenient route back towards the village at the end of the day. The area is particularly appealing for guests who value a quieter atmosphere while still benefiting from excellent connections to the wider resort.

Courchevel Village provides everything needed for a comfortable stay, including ski hire shops, cafés, relaxed restaurants and family friendly services. The gentle nursery zones nearby are ideal for beginners, while more confident skiers can explore a wide variety of red and black runs across the valley. Those looking for a different kind of adventure can try snowshoe trails, toboggan runs and scenic winter walks that begin close to the village centre.

Courchevel continues to offer plenty once the skis come off. Guests can enjoy the lively après scene at local bars or take the short gondola ride to neighbouring districts for further dining and entertainment options. With reliable snowfall and a welcoming alpine atmosphere, Courchevel Village remains a favourite for those seeking a well balanced mountain experience.

Local Amenities

Nearest Airport	Geneva (129 km)
Nearest Airport	Lyon (181 km)
Nearest Bar/Pub	Les Perles du Palais (110 m)
Nearest Piste	Tovets (20 m)

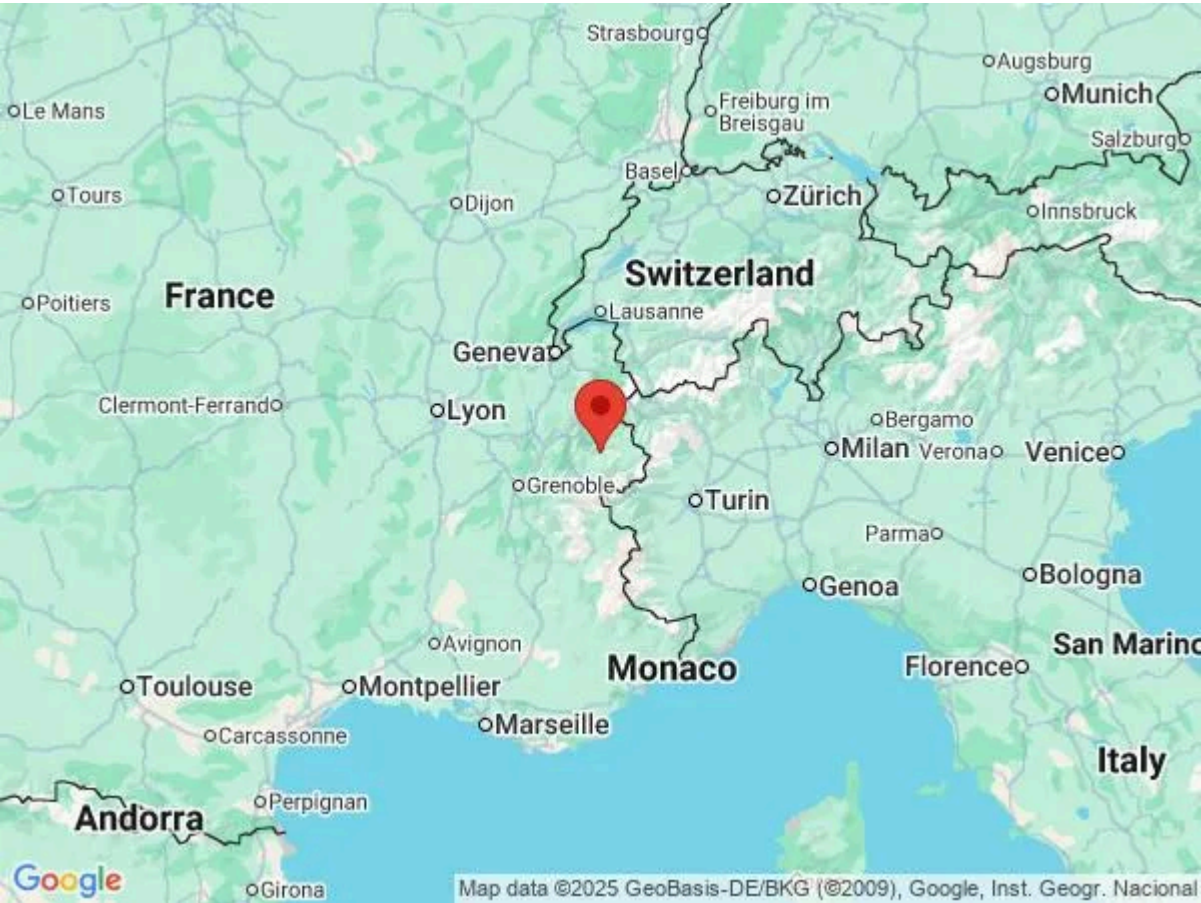

Nearest Restaurant	La Chapelle 1550 (140 m)
Nearest Ski Hire	Intersport - Courchevel Village (20 m)
Nearest Ski Lift	Roys (Button Lift, access to Grangettes) (20 m)
Nearest Ski Lift	Grangettes (100 m)
Nearest Supermarket	Proxi Supermarché (150 m)
Nearest Village	Courchevel Village (50 m)

What we love

- Enjoying a superb location in the centre of Courchevel, Apartment Theo is less than five minutes from the ski lift, perfect for those looking to hit the slopes early.
- Part of a newly built residence, the apartment enjoys hotel-like services, with a reception and concierge, as well as access to a shared fitness suite and well-being centre.
- Immaculately presented, Apartment Theo has been designed with comfort in mind, with a warm interior that reflects that natural alpine setting.

What you should know...

- Please note that the parking is located in the underground carpark and may not be suitable for larger vehicles or those with roof boxes.
- Being on the 3rd floor, the building is serviced by a lift and there is a ski locker in the basement to store all of your kit.
- The property is close to the slopes but not technically ski-in/ski-out, with a road inbetween the piste and residence.

Terms & Conditions

- **Security deposit:** Secure link sent to the client's email to fill in the details of the client's bank card online 2 weeks before the arrival for the amount of €1000. This is in the form of a card authorisation, funds are not cashed
- **Arrival time:** Check-in 5.00 PM.
- **Departure time:** Check-out 10.00 AM.
- **Energy costs included?:** Yes, included in the rental price.
- **Linen & towels included?:** Yes, included in the rental price.
- **Pets welcome?:** One pet is permitted on request only and with prior agreement with the owner. If accepted, a pet supplement of €100 will apply.
- **Other Ts and Cs:** Please note that rental of a cot and highchair is at an extra cost paid directly to the owner: Cot: 40€ per week Highchair: 30€ per week
- **Changeover day:** Saturday.
- **End of stay cleaning available?:** Yes, end of stay cleaning is included except the kitchen. This does not mean a full clean, just empty bins, empty dishwasher and leave the surfaces generally wiped down. Cleaning teams assess the level of cleaning required, if they feel more work needs to be carried out they will deduct from the deposit. A mid-stay clean is also included
- **Smoking Allowed?:** Smoking & Vaping are not permitted.
- **Minimum stay:** 7 nights.
- **Heating costs included?:** Yes, included in the rental price.
- **Tax:** French Visitors Tax payable alongside balance (typically costs €1-€5 per adult per night- please enquire if exact amount is required).
- **Internet access?:** Yes, Wi-Fi and internet included in rental price.