

Hudson Townhouse

Region: Bath Sleeps: 5

Overview

Hudson Townhouse is a charming and quirky Georgian property, thoughtfully converted back from a shop to create a unique and comfortable living space. The house spans four storeys, featuring three cosy bedrooms, a basement kitchen, a diner, and a family bathroom. With a private courtyard at the back, this townhouse offers a delightful retreat in the heart of Bath.

The entrance to Hudson Townhouse opens to a warm and welcoming reception room adorned with wooden floors, contemporary paintwork, and a plush rug. The mid-19th Century shopfront's floor-to-ceiling glazing and an additional sash window bathe the room in natural light throughout the day. Plantation shutters ensure a cosy atmosphere in the evenings, inviting relaxation on the L-shaped three-seater sofa for TV streaming or socialising with friends.

Heading downstairs reveals a spacious open-plan kitchen and dining room, skilfully designed with half the space dedicated to each function. Large, glazed doors connect the room to converted vaults, allowing ample daylight to illuminate this basement area. The kitchen boasts a contemporary utilitarian design, complete with a range of modern appliances, including a tall Smeg fridge, induction hob, electric cooker, and family-sized dishwasher.

A rustic wooden farmhouse table defines the dining area, providing seating for eight on upholstered chairs, while period-style crystal and brass wall sconces add an elegant touch for a delightful dinner party. The converted vaults cleverly house a cosy study and a large utility room.

On the first floor awaits the spectacular master bedroom, painted in a calming blue hue, with white plantation shutters and a decorative period fireplace. The king-size bed adorned with premium quality Egyptian cotton bedding ensures a restful night's sleep. Across the landing is the family bathroom, beautifully themed in blue and white, offering a separate glass-encased shower and a full-length bath, ideal for relaxation.

The second floor accommodates another king-size bedroom, featuring calming neutrals and rooftop views across Lansdown Road and beyond. Across the landing, a third bedroom with a double bed provides views of Christ Church at the back of the building, and there's an additional toilet and washbasin for added convenience.

Hudson Townhouse offers exclusive access to the entire property and the private courtyard, providing families with a comfortable and delightful home away from home. Situated opposite Hedgemoor Park, families can enjoy leisurely walks, playtime at the park's playground, and easy access to the city's vibrant attractions, shops, cafes, bars, and festivals that Bath is renowned for.

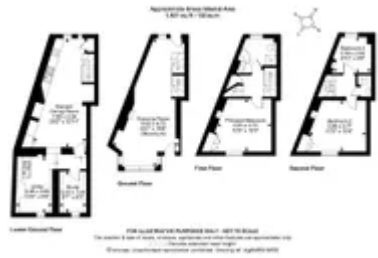

Facilities

Wi-Fi/Internet • Easy By Train • City Homes & Apartments • Modern • Kid-friendly museum • Kid-friendly excursions • Ideal for Babies & Toddlers • Ideal for Kids • Pets on Request • Walk to Village • Washing Machine • Tumble Dryer • Dishwasher • Microwave • Coffee Machine • High Chair(s) • On-Street Parking • Tourist Towns & Villages • Historical Sites

Interior & Grounds

The House

Charming and quirky Georgian property, thoughtfully converted back from a shop to create a unique and comfortable living space.

Interior

Ground Floor

- Reception Room
- Small hallway

Basement

- Open plan kitchen and dining room
- Study
- Large Utility Room

First Floor

- Master Bedroom: King-size bed and fireplace
- Family Bathroom: Shower and full-length bath

Second Floor

- Bedroom 2: King-size bed and rooftop views
- Bedroom 3: Double bed with views of Christ Church
- Bathroom

Exterior

- Courtyard
- Paid parking off premises

Additional Facilities

- Wi-Fi
- Heating
- TV
- Iron
- Bathroom products
- High chair (on request)



Location & Local Information

Hudson Townhouse enjoys a prime location on Old Orchard Street, a quiet backwater nestled in Bath's bustling city centre. This charming Georgian townhouse is part of the Belvedere stretch of terraced townhouses perched on the lower slopes of Lansdown. The street's elegant and historic architecture exudes the quintessential Bath charm, with its elevated pavement and picturesque views across the city rooftops.

Situated opposite Hedgemoor Park, the townhouse benefits from a serene and green setting, offering a peaceful respite amidst the vibrant cityscape. The park's sloping lawns and play area with swings and climbing frames provide a delightful spot for families to enjoy outdoor activities. The surroundings reflect the rich history of Bath, with hidden secrets and stories waiting to be discovered.

The location is conveniently close to the heart of the city, allowing easy access to the city's renowned attractions and amenities. A leisurely stroll downhill takes you to the Assembly Rooms, Royal Circus, and the artisan quarter of Walcot Street, each offering unique experiences and opportunities to immerse in Bath's cultural and artistic essence.

The townhouse's central position places it within a short walk of an exceptional selection of High Street and independent shops, cosy cafes, trendy bars, and a vibrant nightlife scene that has enchanted visitors for centuries. Bath is a city brimming with festivals celebrating art, literature, music, and theatre, providing families with enriching cultural experiences throughout the year.

Sports enthusiasts will find themselves at home in Bath, which is home to Bath Rugby, a team deeply ingrained in the city's culture and history. Additionally, popular attractions such as The Roman Baths, Victoria Art Gallery, Bath Abbey, Pulteney Bridge, and the Thermae Spa are all within a comfortable fifteen-minute stroll through the charming streets and alleys.

Families visiting Hudson Townhouse have the opportunity to participate in an excellent selection of guided walks, ghost tours, history tours, comedy tours, and open-top bus and riverboat trips, all contributing to a fun-filled and exciting stay in this captivating city.

With its unbeatable location, Hudson Townhouse allows families to immerse themselves in the timeless charm and vibrant atmosphere of Bath while enjoying a comfortable and unique living space.

Local Amenities

Nearest Airport	Heathrow Airport (163 km)
Nearest Train Station	Bath Spa (2 km)
Nearest Supermarket	Waitrose & Partners (550 m)



What we love

- Hudson Townhouse offers a quirky and sensitively converted space, blending period features with modern comforts, creating a unique and charming ambiance
- The spacious open plan kitchen/dining room in the basement is flooded with natural light, providing a delightful setting for social gatherings!
- The spectacular master bedroom with calming blue tones encourages guests to enjoy a peaceful and stylish retreat during their stay

What you should know...

- Sadly, private parking is not available – if coming by car we recommend parking at Charlotte Street car park, or Southgate Car park which has electric charging points, or using the Lansdown Park & Ride scheme
- Bath Spa train station, the Coach station, along with most of the city, is within 15 minutes' walk from the property
- You will be greeted on the day by a member of our team

Terms & Conditions

- **Security deposit:** Please note that this property manager works with SUPERHOG. Once your booking is confirmed, you will be contacted by SUPERHOG directly to verify yourself and finalise the process. In the unlikely event that SUPERHOG is unable to provide the necessary damages cover, you would be required to provide a physical damages deposit prior arrival.
- **Arrival time:** 15:00 - 20:00
- **Departure time:** 10:00
- **Energy costs included?:** Yes, included in the rental price.
- **Linen & towels included?:** Yes, included in the rental price.
- **Pets welcome?:** On request only and with prior agreement with the owner.
- **End of stay cleaning available?:** Yes. However, guests are required to leave the accommodation clean, tidy and in the same condition as on their arrival. Any extra cleaning, laundry, maintenance and/or rubbish disposal required will be charged against the security deposit.
- **Smoking Allowed?:** Smoking & Vaping are not permitted.
- **Minimum stay:** 3 nights.
- **Heating costs included?:** Yes, included in the rental price.
- **Internet access?:** Wi-Fi internet access included.
- **Stag & Hen Do Allowed? :** Weddings, stag/hen parties and any special events are not allowed.