

The Siam - Premier River View Suite

Region: Bangkok Sleeps: 3

Overview

Please note that this room is available on request. Availability will be confirmed once we receive your booking enquiry.

The Premier River View Suite invites you to wake up to serene, picture-perfect views of a peaceful stretch of the Chao Phraya River, offering a soothing contrast to the vibrant energy of Bangkok. Spanning an impressive 100 square metres, this sought-after suite features floor-to-ceiling windows that flood the space with natural light, along with a palatial bathroom designed to make every guest feel truly pampered. As one delighted guest put it: "Decoration out of this world! The quality of the bed is like heaven!"

Every stay at The Siam is enhanced with a thoughtful range of inclusions to ensure an effortless and indulgent experience. Guests enjoy a daily breakfast at the hotel's restaurant, attentive butler service, and complimentary Wi-Fi throughout the property. A charming shuttle boat provides seamless travel between the hotel and Bangkok's central Sathorn Pier, offering a scenic and convenient way to explore the city.

Facilities

Resort • Excursions Available • 24hr Reception • Half board Options • Onsite Restaurants • Tennis Nearby • Air-Con • Wine Tasting • Historical Sites • Walk to Village • Maid Service Included • Special Offer • Has Discount • All Bedrooms En-Suite • Shared Pool • <1hr to Airport • Walk to Restaurant • Wi-Fi/Internet • Coffee Machine • Outstanding Landscapes • Outdoor Pursuit & Activities • Hairdryer • Tourist Towns & Villages • Laptop Friendly Workspace • Safety Deposit Box • Smart TV • Heating • Half Board • Spa Treatments Available • Transfers Available • On-Site Concierge • Breakfast Included • Meal delivery service • Bathroom Toiletries • Ideal for Babies & Toddlers

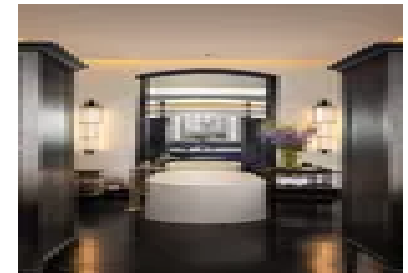
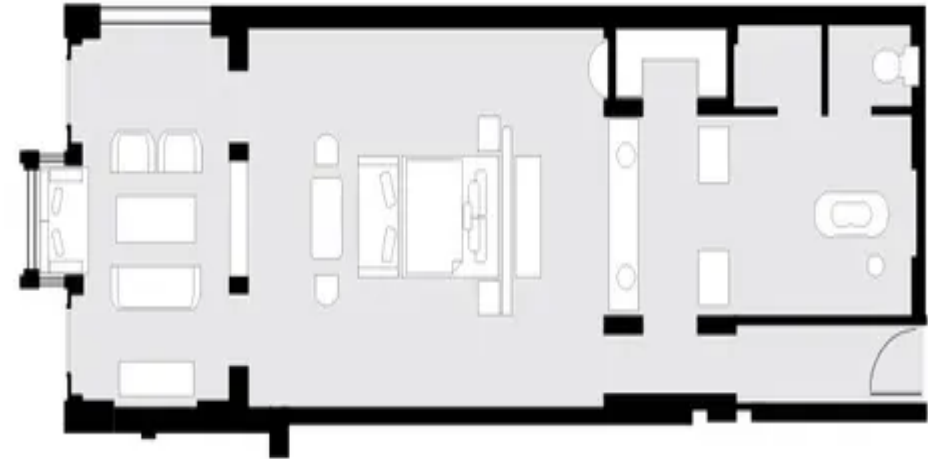

Interior & Grounds

Interior

- Bedroom with king or twin size
- Small dining/sitting area
- Bathroom with bathtub and walk-in shower

Exterior

- Small balcony with outdoor sitting

Additional Facilities

- Daily breakfast for two at restaurant
- Complimentary minibar (snacks & non-alcoholic beverages; replenished daily)
- Complimentary WiFi property wide
- Daily fresh tropical fruit
- Shuttle boat between the hotel and Bangkok's central Sathorn pier



Location & Local Information

The Siam resort is nestled in the tranquil and historic Dusit district of Bangkok, Thailand, along the picturesque Chao Phraya River. This unique location offers a serene escape from the fast-paced energy of central Bangkok while still being within easy reach of the city's key attractions. Dusit is known for its regal charm, featuring grand palaces like the Vimanmek Mansion, traditional temples such as Wat Benchamabophit (the Marble Temple), and lush, expansive parks like Dusit Zoo and Suan Amporn.

The area exudes a sense of old-world elegance, with its tree-lined avenues and proximity to some of Bangkok's most notable cultural landmarks, including the Ananta Samakhom Throne Hall. Despite its peaceful vibe, Dusit remains well-connected, with the rest of the city just a short boat ride or drive away, allowing guests at The Siam to enjoy the perfect balance between riverside relaxation and Bangkok's dynamic urban life.

Local Amenities

Nearest Airport	Suvarnabhumi Airport (31 km)
Nearest Bar/Pub	Kuakarun Bar (130 m)
Nearest Golf	Prachachuen Golf Driving Range (15 km)
Nearest Restaurant	Deco Bar & Bristo (220 m)
Nearest Supermarket	7-Eleven (850 m)
Nearest Tennis	Noah Asia (16 km)
Nearest Town/City	Bangkok City (4 km)
Nearest Train Station	Sung Hi Junction (700 m)
Nearest Village	Dusit District (500 m)

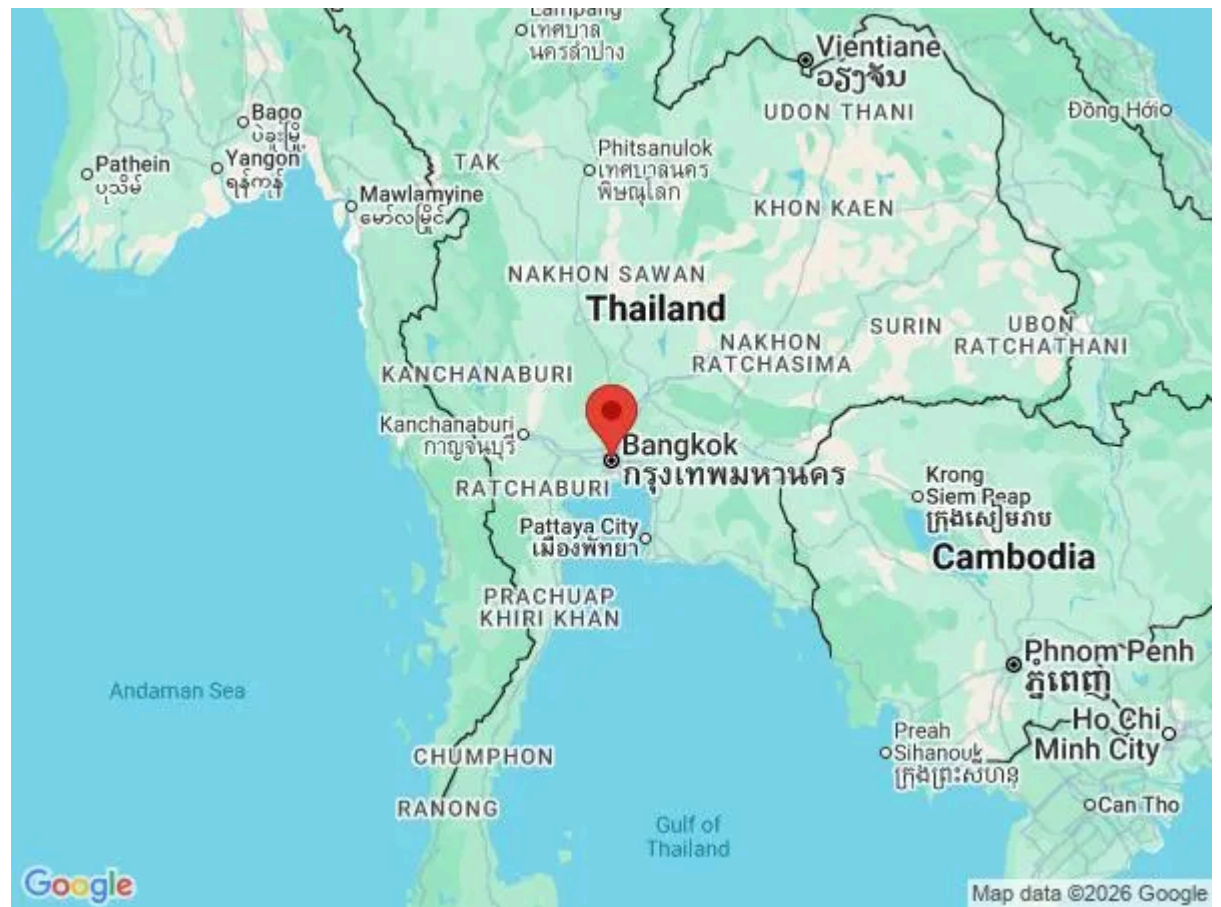

What we love

- Waking up in the The Siam Hotel's Premier River View Suite means enjoying a spacious 100 m² river-front haven with floor-to-ceiling windows and serene views over a calm stretch of the Chao Phraya River.
- With tasteful Art-Deco design, elegant dark-wood furnishings and a palatial bathroom, the suite blends boutique-hotel charm with refined comfort, perfect for couples or small groups seeking luxury in the heart of Bangkok.
- Guests also enjoy perks like daily breakfast, dedicated butler service and a private shuttle-boat to the city's central pier, ideal for combining relaxation with easy access to Bangkok's vibrant sights.

What you should know...

- Keep cautious near windows and glass-fronted areas, the floor-to-ceiling windows can feel dramatic but may increase glare or slipping risk when wet.
- As the hotel relies on river-front access and a boat shuttle rather than typical street access, allocate extra time for arrivals, departures or city trips.
- The suite, and indeed much of the hotel, is decorated with antiques and vintage items, so take care when moving around to avoid damage or knocking fragile décor.
- Please note that this room is available on request. Availability will be confirmed once we receive your booking enquiry.

Terms & Conditions

- **Security deposit:** Credit card details are required 2 weeks prior to departure for pre-authorisation.
- **Arrival time:** 2 pm
- **Departure time:** 12 pm
- **Energy costs included?:** Yes, included in the rental price.
- **Linen & towels included?:** Yes, included in the rental price.
- **Pets welcome?:** Not allowed.
- **Changeover day:** Flexible.
- **Smoking Allowed?:** Smoking & Vaping are not permitted.
- **Minimum stay:** 2 - 3 nights, depending of season. All other durations on request.
- **Heating costs included?:** Yes, included in the rental price.
- **Tax:** Government tax and service charge included in the rental price.
- **Internet access?:** Wi-Fi internet access included.
- **Pool towels included?:** Yes, included in the rental price.