

Domaine Du Pont - Chateau Only

Region: Normandy **Sleeps:** 18

Overview

A magnificent 17th century château set in stunning landscaped gardens, the château is the perfect base to explore the Bayeux Tapestry, Monet's Garden, and the landing beaches. It is only a 14km-drive drive from Honfleur and 30km from Deauville.

The main château at Domaine Du Pont can sleep up to 16 to 18 guests across nine beautiful bedrooms. The ground floor entertaining spaces are superb with antique chandeliers and other original features whilst three of the rooms open up to the gardens, especially wonderful in the summer months. In the old stable block there is a heated swimming pool and pool house whilst outside you will also find the formal and Italian garden as well as the grand fountain which can be switched on in summer months.

The outside of the estate has been untouched since it was originally built in the 16th century and enlarged in around 1720. The interior is fully modernised, though. It has had a fascinating history, from being used as a safe house for aristocrats being smuggled out of France during the revolution, to being used by the Resistance during the Second World War. Since the war the château has had a much more refined and tranquil existence, but has also played host to guests such as the Aga Khan and the Dalai Lama.

Facilities

Cots (Cribs) • Chateaux & Castles • Tennis Nearby • Rural Location • Indoor Games • Maid Service Available • DVD • Beach Nearby • Wi-Fi/Internet • Games Room • Golf Nearby • Heritage Collection • Catering Available • Babysitting Available • Private Pool • Pool Safety Feature • Heated Pool • Ideal for Babies & Toddlers • Ideal for Kids • Ideal for Teens • Pets on Request • TV • Outdoor Games • Working Fireplace/Woodburner • Heating • Conference Facilities • Caretaker/Owner on Site • High Chair(s) • Fenced Grounds • Sailing • Walking/Hiking Paths • Cycling • Horse Riding • Fishing • Outstanding Landscapes • Outdoor Pursuit & Activities • Tourist Towns & Villages • Historical Sites

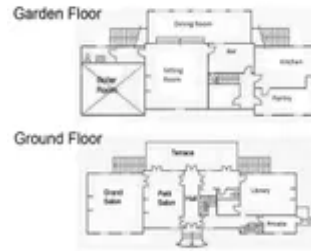

Interior & Grounds

Château Interiors

Main Floor

- Hallway
- Drawing room
- Morning room
- Library with sofa
- Access to terrace overlooking formal gardens and fountain
- WC (x2)
- Study (closed off)

Garden Floor

- Kitchen and pantry, fully-equipped
- Single split-level space with sitting room with large screen TV and fireplace and dining room with two circular dining tables (seating 18 in total) and doors leading to garden

First Floor

- Suite with double bedroom, salon and en suite bathroom
- 2 x bedrooms with double bed and en suite bathroom
- Library (closed off)

Second Floor

- 4 x bedrooms with double bed
- 2 x bedrooms with twin beds
- 3 x shower rooms

Outside Grounds (50 hectares)

- Heated swimming pool (12x6m), open approximately June to end-September
- Pool house with two changing/shower rooms, modern kitchen and function room with gallery for dining (28 guests)



- Al-fresco dining terrace for up to 18 guests (on terrace overlooking formal gardens and fountain)
- Formal gardens
- Fountain (on request in summer months)
- Walled Italian garden
- Orchard (apples, pear, fig, mulberry and walnut tree)
- Woodland
- Outbuildings (not available to guests)
- Parking spaces

Location & Local Information

The nearest port to the château is Le Havre (35km) and the nearest town is Beuzeville (5km). About three minutes drive from the château there is a small village which has a butcher's, a baker's, and a takeaway pizza restaurant, which is good for emergencies! There is also a very nice French restaurant. If you want to try slightly further afield (just another 10 minutes!) you will find many good restaurants in the picturesque setting of Honfleur, a medieval fishing port. If you go further afield to Deauville (30km), there are a number of very smart restaurants as well as a lovely sandy beach.

Normandy has a huge amount to offer – and most of it is within a reasonable drive of the château. It has something for everyone from old cities, Monet's garden, the landing beaches and historic sites such as the Bayeux tapestry to beaches, holiday resorts and casinos.

The area is well supplied in terms of sports facilities - for both participants and spectators. In particular, it is well known as a hub for equine pursuits - there are numerous studs, including the Aga Khan's, and in the summer there are horse auctions and Horse Racing and Polo at Deauville. There is also Horse Riding available locally. There are many golf courses within 30 minutes of the chateau, or the one in Etretat, situated on top of the cliffs, overlooking the channel, 57 km away.

Other day trips include the Landing Beaches, the Bayeux Tapestry and Monet's Garden. Honfleur (17km) is a fishing and sailing port located in the Seine estuary about 15 minutes from the château. Deauville (30km) is great for smart shops, cafes and people watching. This cosmopolitan sea-side resort has a large and beautiful beach, a marina, and a casino.

Normandy is rightly famous for its food - especially the cheeses such as Livarot Camembert, and Pont l'Eveque - and Calvados, the apple brandy. The French love of good food means that all ingredients also have to be of the highest quality. Seafood is fantastic and local producers are famous in the area for quality, taste, and price.

Local markets are fantastic and are often the major source of food for the locals. The nearest market is in Beuzeville on Tuesday mornings. However, there are also excellent ones in Honfleur (Saturday), Trouville (Sunday) and Pont Audemer (Monday). There are many restaurants in nearby villages. also many restaurants in nearby villages – the best guide to them is the Michelin Guide.

Local Amenities

Nearest Airport	Deauville (22km)
Nearest Ferry Port	Le Havre (35km)
Nearest Village	(2km)



Nearest Town	Beuzeville (5km)
Nearest Restaurant	Local village (2km)
Nearest Shop	Supermarket in local village (2km)
Nearest Beach	Nr Honfleur (18km)
Nearest Golf	Golf Barrière de Deauville (28km)
Nearest Tennis	Beuzeville (5km)

What we love

- The Dalai Lama has stayed here on several occasions!
- Dating back to the 17th century, learn all about the château's fascinating history
- The landscaped gardens are beautiful with statues and a fountain
- You must not forget to visit the Bayeux Tapestry, it's only a short drive away
- The area is well supplied in terms of sports facilities and is well known as a hub for equine pursuits

What you should know...

- The estate also features a farmhouse in the neighbouring field which is also available to book either separately (see Domaine Du Pont - Farmhouse (<https://www.oliverstravels.com/france/normandy/domaine-du-pont-farmhouse/>)) or together with the château (see Domaine Du Pont - Entire Estate (<https://www.oliverstravels.com/france/normandy/domaine-du-pont-entire-estate/>)).
- Please note that there are two Estate Guardian dogs living 18 metres from the château.
- Any pets must be kept on a leash, with their owner at all times, and are restricted to the gardens behind the château.

Terms & Conditions

- **Security deposit:** £1500 charged to client's credit card by Oliver's Travels as a pre-authorisation at least 2 weeks prior to arrival and refunded two weeks after departure, subject to full inspection. Any extra charges such as heating costs will be deducted from the security deposit.
- **Arrival time:** 5.00 p.m. onwards.
- **Departure time:** 10.00 a.m.
- **Energy costs included?:** Heating is charged to expenditure if needed. Firewood is provided free of charge.
- **Linen & towels included?:** Yes. Please note that guests are asked to strip the sheets for check out.
- **Pets welcome?:** On request only and with prior agreement with the owner. Any pets must be kept on a leash, with their owner at all times and are restricted to the gardens behind the château.
- **Other Ts and Cs:** Weddings, stag/hen parties and any special events are not allowed.
- **Changeover day:** Saturday in July and August, Christmas and New Year. Flexible in all other periods.
- **End of stay cleaning available?:** Yes. However, guests are required to leave the accommodation clean, tidy and in the same condition as on their arrival. Any extra cleaning, laundry, maintenance and/or rubbish disposal required will be charged against the security deposit.
- **Smoking Allowed?:** Outside only.
- **Insurance:** Guests are required to be in possession of a valid insurance policy, which covers them for cancellations, personal belongings, public liability and any accidental damage caused during their stay.
- **Minimum stay:** 7 nights in July and August, Christmas and New Year. 4 nights in all other periods.
- **Pool heating charge?:** The pool is heated to 26C free of charge - any higher is charged at cost, payable locally. Please note that like all heated pools, pool heating and water temperature are reliant on weather and outside temperatures.
- **Pool opening dates?:** The pool is open approximately June to end-September. Please note that pool opening dates are subject to local weather conditions and pool maintenance requirements and that cooler months may not be suitable for swimming.